



LIVE ELECTRICAL DISTRIBUTION UK LTD

4 Queensmead Place, Textilose Road, Manchester, M17 1PH  
Tel: 0161 8702592 Web: [www.liveelectrical.co.uk](http://www.liveelectrical.co.uk)  
E-mail: [sales@liveelectrical.co.uk](mailto:sales@liveelectrical.co.uk)



Ensure that these instructions are made available to the end user for future reference.

© Product installation and operation guide



## DC MINIATURE CIRCUIT BREAKERS

# DC MINIATURE CIRCUIT BREAKERS

## Technical Data

- Rated current  $I_n$  (A) :6,10,16,20,25,32,40,50,63.
- Rated voltage  $U_e$ (DC): 600V(2P).1000V(4P)
- Rated breaking capacity(A): 6KA .
- Thermo-magnetic release characteristic: C.
- Contact position degree: IP20 .
- IEC/EN60898-2.
- Cable terminal capacity maximum : 16mm<sup>2</sup>

## Dimensions

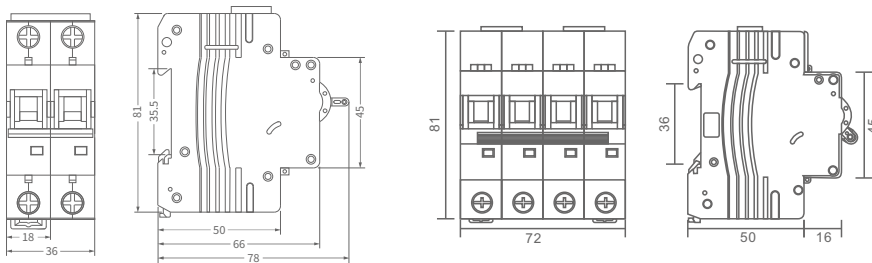

## Wiring Diagram

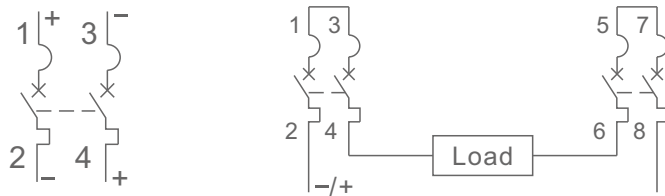

## Installation

1. The MCB is installed in the distribution box, distribution cabinet or box using the TH35-7.5 steel mounting rail.
2. Generally, the MCB should be installed vertically, with the handle facing upward to power on
3. There should be no significant impact and vibration at the installation place
4. Connection method: Tighten the connection with screws
5. The external magnetic field of the installation site shall not exceed 5 times of the earth magnetic field in any direction
6. Installation and disassembly:

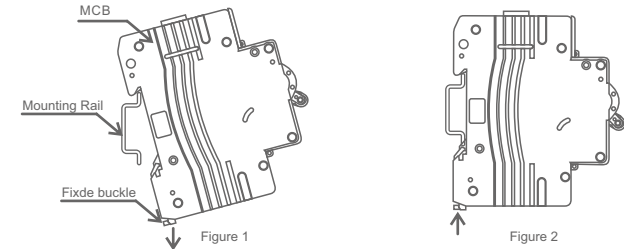

a. Installation: Pull the fixed buckle of the MCB down in the direction of arrow 1 according to Figure 1, and then put the MCB in align the rail with the upper end of the installation guide rail (see Figure 1), and ensure that the bottom of the MCB is fully aligned with the installation guide rail. After that (see Figure 2), push the fixed buckle of the MCB into the lower end of the installation guide rail according to the arrow direction in Figure 2 to release it.

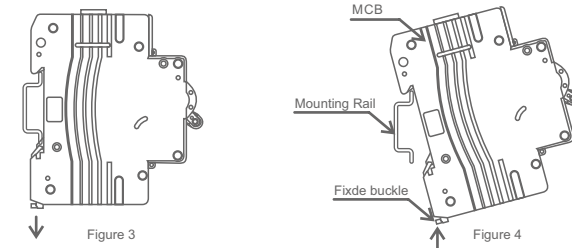

b. Disassemble: Pull the fixed buckle of the MCB down in the arrow direction as shown in Figure 3, and then pull the MCB as shown in Figure 4. The lower end of the MCB is lifted up and pushed upward, then the MCB can be removed.

## Note:

1. Before connecting, please ensure that the power supply is off.
2. Install the MCB correctly on the switchboard.
3. When using the MCB, pay attention to whether the rated current of the electrical equipment is lower than the rated current of the MCB to avoid overload.
4. When the circuit occurs short circuit, overload or leakage, the MCB will automatically trip and power off, cutting off the circuit to ensure personal safety and equipment safety.
5. Before use, check whether the shell of the MCB has abnormal conditions, such as burning, deformation, fracture, etc. If found, it should be replaced in time.
6. In the use of MCB, should be in accordance with the rated current selection, can not be used over load.
7. When cleaning the MCB, wipe it with cotton cloth or paper towels. Do not use corrosive chemicals to clean it.
8. After the MCB is tripped, the circuit should be carefully checked to eliminate the cause of the fault in time.